



FIELDHOUSE

T: +44 (0)20 7013 0770
F: +44 (0)20 7731 1964
PROPERTY@FHRES.CO.UK
FHRES.CO.UK



Apartment 4 1a Star Street, London, W2 1QD

UNFURNISHED ONE DOUBLE BEDROOM well-proportioned Second Floor Flat located within the heart of Paddington. The property benefits from Open Plan Lounge/Kitchen with ample space for Dining and Relaxing, Double Bedroom with integrated storage and modern bathroom with Shower over Bath. The property has hard wood floors throughout the open plan kitchen and lounge and carpets in the hallway and bedroom. Available Beginning of March 2026.

Located close to the various amenities of Paddington Central and Edgware Road, the property has excellent transport links including Edgware Road and Paddington Underground Stations (Hammersmith & City, Circle, District and Bakerloo Lines).

- ONE DOUBLE BEDROOM
- OPEN PLAN LOUNGE/KITCHEN
- BATHROOM
- GAS CENTRAL HEATING
- SECOND FLOOR
- AVAILABLE BEGINNING OF MARCH 2026

£2,350 PCM*

Second Floor

Approx. 48.5 sq. metres (522.0 sq. feet)

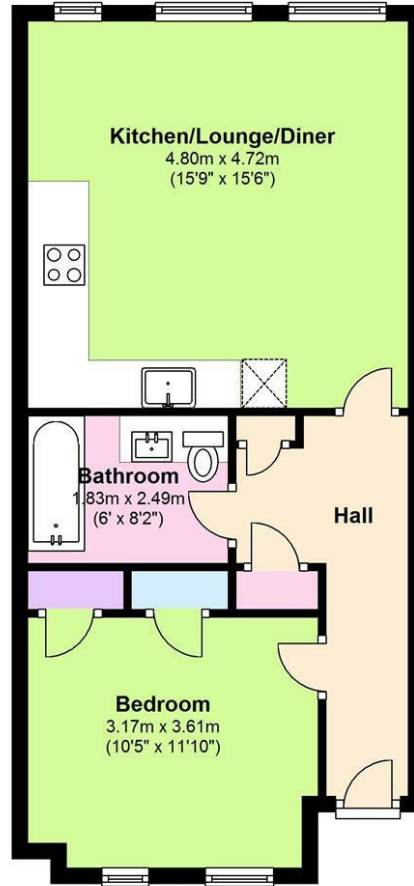

Total area: approx. 48.5 sq. metres (522.0 sq. feet)

Energy Efficiency Rating		
	Current	Potential
Very energy efficient - lower running costs		
(92 plus) A		
(81-91) B		
(69-80) C		
(55-68) D		
(39-54) E		
(21-38) F		
(1-20) G		
Not energy efficient - higher running costs		
England & Wales	83	83
EU Directive 2002/91/EC		

Environmental Impact (CO ₂) Rating		
	Current	Potential
Very environmentally friendly - lower CO ₂ emissions		
(92 plus) A		
(81-91) B		
(69-80) C		
(55-68) D		
(39-54) E		
(21-38) F		
(1-20) G		
Not environmentally friendly - higher CO ₂ emissions		
England & Wales	87	87
EU Directive 2002/91/EC		



FIELDHOUSE RESIDENTIAL LIMITED

Registered Address: 94 Wandsworth Bridge Road, London SW6 2TF
Registered in England No. 5097508 VAT No. GB 839 5267 87

